

user manual



F 2285N A+
F 2285N A+ +

Cylinda
år efter år

Index

BEFORE USING YOUR FRIDGE	2
General warnings	2
Safety warnings	4
Installing and operating your freezer	5
Before Using your Freezer	6
Information on No-Frost Technology	6
USAGE INFORMATION	7
Operating your Freezer	7
<i>MODE Button</i>	7
<i>SET Button</i>	7
<i>Freezer Department Temperature Adjustment and Activating FAST FREEZING Mode</i>	8
<i>Fast Freezing Mode</i>	8
<i>While SF mode is selected:</i>	9
<i>Economy mode</i>	9
Warnings about Temperature Adjustments	10
Accessories	10
<i>Making Ice Cubes (Ice matic - If available)</i>	10
PLACING THE FOOD	10
CLEANING AND MAINTENANCE	15
Defrosting	15
SHIPMENT AND REPOSITIONING	16
Repositioning the door	16
BEFORE CALLING SERVICE	17
Advice for Saving Energy	20
THE PARTS OF THE APPLIANCE AND THE COMPARTMENTS	21

General warnings

WARNING: Keep ventilation openings, in the appliance enclosure or in the built-in structure, clear of obstruction.

WARNING: Do not use mechanical devices or other means to accelerate the defrosting process, other than those recommended by the manufacturer.

WARNING: Do not use electrical appliances inside the food storage compartments of the appliance, unless they are of the type recommended by the manufacturer.

WARNING: Do not damage the refrigerant circuit.

WARNING: To avoid a hazard due to the instability of the appliance, it must be fixed in accordance with the instructions.

- If your appliance uses R600a as a refrigerant – you can learn this information from the label on the cooler- you should be careful during shipment and installation to prevent your appliance's cooler elements from being damaged. Although R600a is an environmentally friendly and natural gas. As it is explosive, in the event of a leak due to damage to the cooler elements, move your fridge from open flame or heat sources and ventilate the room where the appliance is located for a few minutes.
- While carrying and positioning the fridge, do not damage the cooler gas circuit.
- Do not store explosive substances such as aerosol cans with a flammable propellant in this appliance.
- This appliance is intended to be used in household and similar applications such as;
 - staff kitchen areas in shops, offices and other working environments
 - farm houses and by clients in hotels, motels and other residential type environments

- bed and breakfast type environments;
- catering and similar non-retail applications
- If the socket does not match the refrigerator plug, it must be replaced by the manufacturer, its service agent or similarly qualified persons in order to avoid a hazard.
- This appliance is not intended for use by persons (including children) with reduced physical, sensory or mental capabilities, or lack of experience and knowledge, unless they have been given supervision or instruction concerning use of the appliance by a person responsible for their safety. Children should be supervised to ensure that they do not play with the appliance.
- A specially grounded plug has been connected to the power cable of your refrigerator. This plug should be used with a specially grounded socket of 16 amperes. If there is no such socket in your house, please have it installed by an authorized electrician.
- This appliance can be used by children aged from 8 years and above and persons with reduced physical, sensory or mental capabilities or lack of experience and knowledge if they have been given supervision or instruction concerning use of the appliance in a safe way and understand the hazard involved. Children shall not play with the appliance. Cleaning and user maintenance, shall not be made by children without supervision.
- If the supply cord is damaged, it must be replaced by the manufacturer, its service agent or similar qualified persons in order to avoid a hazard.

Old and out-of-order fridges

- If your old fridge has a lock, break or remove the lock before discarding it, because children may get trapped inside it and may cause an accident.
- Old fridges and freezers contain isolation material and refrigerant with CFC. Therefore, take care not to harm environment when you are discarding your old fridges.



Please ask your municipal authority about the disposal of the WEEE for the reuse, recycle and recovery purposes.

Notes:

- Please read the instruction manual carefully before installing and using your appliance.
We are not responsible of the damage occurred due to misuse.
- Follow all instructions on your appliance and instruction manual, and keep this manual in a safe place to resolve the problems that may occur in the future.
- This appliance is produced to be used at houses and it can only be used in house and for the specified purposes. It is not suitable for commercial or common use. Such use will cause the guarantee of the appliance to be cancelled and our company will not be responsible for the losses to be occurred.
- This appliance is produced to be used in houses and it is only suitable for cooling / storing foods. It is not suitable for commercial or common use and/or for storing substances except for food. Our company is not responsible for the losses to be occurred in the contrary case.

Safety warnings

- Do not use multiple receptacles or extension cord.
- Do not plug in damaged, torn or old plugs.
- Do not pull, bend or damage the cord.



- This appliance is designed for use by adults, do not allow children to play with the appliance or let them to hang over the door.
- Do not plug-in or out the plug from the receptacle with wet hands to prevent electrocution!
- Do not place glass bottles or beverage cans in the freezer. Bottles or cans may explode.
- When taking ice made in the freezer, do not touch it, ice may cause ice burns and/or cuts.
- Do not touch frozen goods with wet hands! Do not eat ice-cream and ice cubes immediately after you take them out of the freezer!

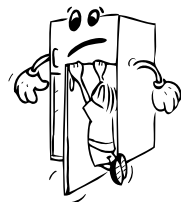

- Do not re-freeze the frozen goods after being melted. This may cause health issues like food poisoning.
- Do not cover the body or top of fridge with lace. This affects the performance of your fridge.
- Fix the accessories in the fridge during transportation to prevent damage to accessories.
- **When the door of the freezer is closed, vacuum will occur. Wait for about 1 minute to reopen it.**
- This application is optional for easy opening door. With this application, a little condensation may occur around this area and you may take it out.

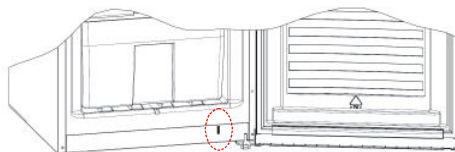

Installing and operating your freezer

Before starting to use your fridge, you should pay attention to the following points:

- Operating voltage for your freezer is 220-240 V at 50Hz.
- We do not take the responsibility of the damages that occur due to ungrounded usage.
- Place your freezer in a place that it would not be exposed to direct sunlight.
- Your appliance should be at least 50 cm away from stoves, Gas ovens and heater cores, and should be at least 5 cm away from electrical ovens.
- Your freezer should never be used outdoors or left under the rain.
- When your freezer is placed next to a deep freezer, there should be at least 2 cm between them to prevent humidity on the outer surface.
- Do not place anything on your freezer, and install your freezer in a suitable place so that at least 15 cm is available on the upper side.
- The adjustable front legs should be stabilized in an appropriate height to allow your freezer operate in a stable and proper way. You can adjust the legs by turning them clockwise (or in the opposite direction). This should be done before placing food in the fridge.
- Before using your freezer, wipe all parts with warm water added with a tea spoonful of sodium bicarbonate, and then rinse with clean water and dry. Place all parts after cleaning.
- Install the distance adjustment plastic (the part with black vanes at the rear) by turning it 90° as shown in the figure to prevent the condenser from touching the wall.

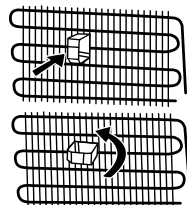

Before Using your Freezer

- When it is operated for the first time or after transportation, keep your freezer in the upright position for 3 hours and plug it on to allow efficient operation. Otherwise, you may damage the compressor.
- Your freezer may have a smell when it is operated for the first time; the smell will fade away when your fridge starts to cool.

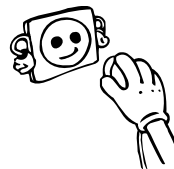

Information on No-Frost Technology

No-frost fridges differ from other static fridges in their operating principle.

In normal fridges, the humidity entering the fridge in the door openings and the humidity of the food causes freezing in the freezer department. To defrost the snow and ice in the freezer department, you should turn off the fridge, take the food that needs to be kept in a constant temperature off the fridge, and remove the ice gathered in the freezer department periodically.

The situation is completely different in no-frost fridges. Dry and cold air is blown to the fridge and freezer departments homogeneously from several points via a blower fan. Cold air dispersed homogeneously even between the shelves cools all your food equally and uniformly, thus prevents humidity and freezing.

Therefore your no-frost fridge allows you ease of use, besides its huge volume and stylish appearance.

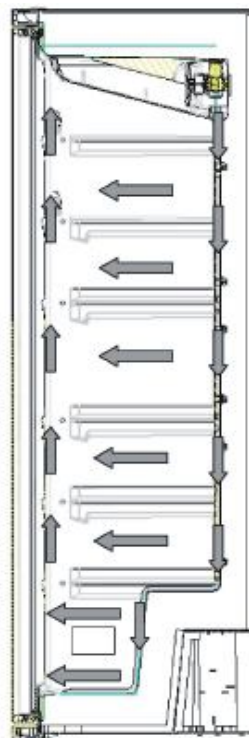

CHAPTER 2. USAGE INFORMATION

Operating your Freezer

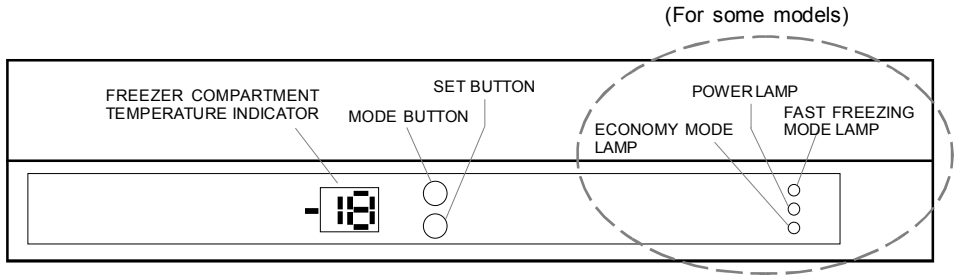

MODE Button

- Mode button allows switching between Freezer Department Indicator, Fast Freezing Mode Lamp, Economy Mode Lamp.
- When you press once, Freezer Department Indicator starts to flash.

Set value is ready to be changed.

- When you press twice, Fast Freezing Mode Lamp starts to flash.
- When you press three times, Economy Mode Lamp starts to flash.

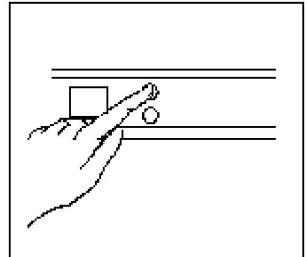

SET Button

Allows the temperature adjustment of the related department when Freezer Department Indicator is selected with the mode button.

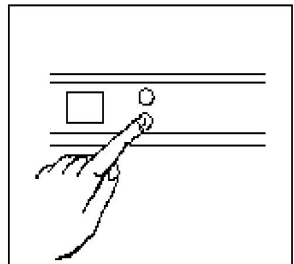

Freezer Department Temperature Adjustment and Activating FAST FREEZING Mode

- Initial temperature value for Freezer Department Indicator is -18°C.
- Press mode button once.
- The set value for freezer Department indicator starts to flash when you press this button.
- The value for freezer Department indicator changes for a lower temperature each time you press this button when the indicator is flashing.

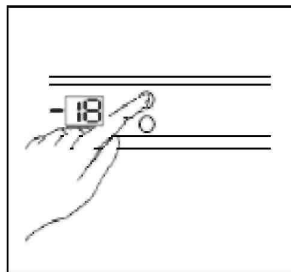

(-16°C, -17°C, -18°C, -19°C, -20°C, -21°C, -22°C, -23°C, -24°C)

- When you wait for 5 seconds without pressing any button after reaching the desired set value, the set value is activated and your fridge operates with that set value.
- When you press set button until the value for Freezer Department Indicator reaches -24°C (maximum cold position), if you press the button again, SF letters will flash.
- If you continue to press the button when SF is flashing, the values will start again from -16°C.

Recommended Temperature Values for Freezer

<i>When would it be adjusted?</i>	<i>Inner Temperature</i>
When small amount of food is stored	-16°C, -17°C
In normal usage	-18°C, -19°C, -20°C, -21°C
When lots of food is stored	-22°C, -23°C, -24°C

Fast Freezing Mode

- To freeze plenty of food
- To freeze ready foods
- To freeze foods rapidly
- To store the seasonal foods for a long time

How to use;

- Press the mode button until Fast Freezing mode.
- While Fast Freezing Mode Lamp is flashing if no button is clicked for 5 seconds then a beep sound will be heard and the mode will be enabled.
- While the Fast Freezing mode is active the letters "SF" will be seen at the Indicator of the Freezer.

While SF mode is selected:

To cancel SF Mode and continue with previous set value:

Please press Mode Button 1 times and wait for 5 secs. SF mode will be cancelled and appliance will start to work according to previous set value.

To cancel SF Mode and continue with new set value:

Please press Mode Button 1 time and in 5 sec, push set button until you see set value you want and wait for 5 secs. SF mode will be cancelled and appliance will start to work according to new set value.

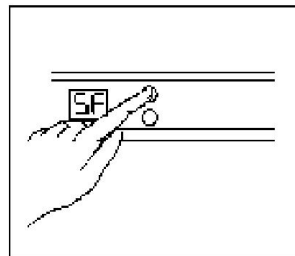

To cancel SF Mode and activate Economy Mode:

Please press Mode Button 3 times and wait for 5 secs. SF mode will be cancelled and appliance will start to work according to Economy Mode.

Note: "Super Freezing" mode will be cancelled automatically after 24 hours or when the freezer sensor temperature falls below -32°C.

If Super Freeze mode is finished automatically, SF led will continue to light. It is enough to push mode button to turn off SF led.

Economy mode

Your freezer will consume minimum energy at -18°C set value which is the most optimum storage condition.

When to use;

- When you want your refrigerator to operate economically.

How to use;

- Press the mode button until Economy Mode Led lights up (3 times).
- While the Economy Mode Led is flashing if no button is clicked then a beep sound will be heard and the mode will be enabled.
- During this mode, the freezer compartment operate at the special temperature value set on the control circuit.
- While the Economy mode is active the letters "Ec" will be seen at the Indicator the Freezer Compartment.

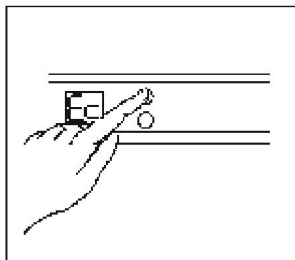

While Economy mode is selected;

To cancel Economy Mode and continue with previous set value:

Please press Mode Button 3 times and wait for 5 secs. Economy mode will be cancelled and appliance will start to work according to previous set value.

To cancel SF Mode and continue with new set value:

Please press Mode Button 1 time and in 5 sec, push set button until you see set value you want and wait for 5 secs. Economy mode will be cancelled and appliance will start to work according to new set value.

To cancel Economy Mode and activate SF Mode:

Please press Mode Button 3 times and wait for 5 secs. Economy mode will be cancelled and appliance will start to work according to SF Mode.

Warnings about Temperature Adjustments

- Your temperature adjustments will not be deleted when an energy breakdown occurs.
- Do not pass to another adjustment before completing an adjustment
- Temperature adjustments should be made according to the frequency of door openings, the quantity of food kept inside the fridge and ambient temperature of the place of your fridge.
- Your fridge should be operated up to 24 hours according to the ambient temperature without interruption after being plugged in to be completely cooled.
- Do not open doors of your fridge frequently and do not place much food inside it in this period.
- A 5 minute delaying function is applied to prevent damage to the compressor of your fridge, when you take the plug off and then plug it on again to operate it or when an energy breakdown occurs. Your fridge will start to operate normally after 5 minutes.

Accessories

Making Ice Cubes (Ice matic - If available)

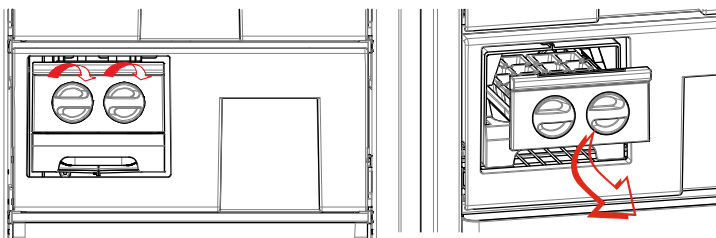

- Take out the ice making tray
- Fill the water in level of line.
- Place the ice making tray in its original position
- When ice cubes are formed, twist the lever to drop off ice cubes into the icebox.

Do not fill the icebox with water in order to make ice. It can be broken.

CHAPTER 3. PLACING THE FOOD

- Use your freezer to keep frozen food for a long time and to produce ice.
- Do not place food you want to freeze next to frozen food.
- You should freeze your food (meat, minced meat, fish etc.) in portions that allow consuming in a time.
- Do not put fresh and warm food with frozen food side by side as it can thaw the frozen food.
- While freezing fresh food (i.e. meat, fish and mincemeat) divide them in parts in order to use in one time.

- For storing the frozen food; the instructions shown on frozen food packages should always be followed carefully and if no information is provided, food should not be stored for more than 3 months from the purchased date.
- Maximum load; if you want to load large quantities and use the maximum net capacity, you can remove the drawers (Except the bottom one). You can store bulky items directly on the shelves.
- When buying frozen food ensure that these have been frozen at suitable temperatures and that the packing is intact.
- Frozen food should be transported in appropriate containers to maintain the quality of the food and should be returned to the freezing surfaces of the unit in the shortest possible time.
- If a package of frozen food shows the sign of humidity and abnormal swelling it is probable that it has been previously stored at an unsuitable temperature and that the contents have deteriorated.
- The storage life of frozen food depends on the room temperature, thermostat setting, how often the door is opened, the type of food and the length of time required to transport the product from the shop to your home. Always follow the instructions printed on the package and never exceed the maximum storage life indicated.
- If you would use maximum freezing capacity of your freezer
- Take the frozen food in the upper basket to other baskets and activate “Fast Freezing” mode. “Fast Freezing” mode will be deactivated automatically after 24 hours. Place the food you want to freeze to the upper basket of the freezer department without exceeding the freezing capacity of your fridge. (Your refrigerator has the capacity to freeze 15 kg at 25°C and 14 kg at 32°C) Then reactivate the “Fast Freezing” mode. You can put your food next to other frozen food after they are frozen (minimum 24 hours after “Fast Freezing” mode is activated for the 2nd time).
- If you would freeze about 3 kg food in your freezer:
- You can place your food without touching other frozen food and activate “Fast Freezing” mode. You can put your food next to other frozen food after they are frozen (after minimum 24 hours).
- Do not re-freeze the frozen goods after being melted. This may cause health issues like food poisoning.
- Do not place hot food to the freezer before cooling them. This may cause the spoiling of food frozen before in the freezer.
- When you are buying frozen food, make sure that they frozen in proper conditions and the package is undamaged.
- Follow the instructions for storing conditions on the package of the frozen food while storing them. If there is no explanation, food must be consumed in a short time.
- If the package of frozen food is humid and smells bad, it may be stored under inappropriate conditions and spoiled. Do not buy this kind of food!
- Storing time for frozen food may differ according to the ambient temperature, frequency of door openings, thermostat adjustments, type of food and the time between the buying of the food and placing of the food in the freezer. Always follow instructions on the package and do not exceed storing period.

For A+ models

If there is a power cut or malfunction, do not open the door. This will help maintain the temperature inside the freezer, ensuring that foods are conserved for about 9,5 hours at 25°C ambient temperature and about 8 hours at 32°C ambient temperature. Do not re-freeze food that is defrosting or that has already been defrosted. These foods must be cooked and eaten.

MEAT AND FISH	Preparation	Storage Duration (months)	Thawing period at room temperature (hours)
Beef Steak	Wrapped in foil	6-10	1-2
Lamb meat	Wrapped in foil	6-8	1-2
Veal roast	Wrapped in foil	6-10	1-2
Veal cubes	In small pieces	6-10	1-2
Lamb cubes	In pieces	4-8	2-3
Minced meat	In the form of oblate packages without being spiced	1-3	2-3
Giblets	In pieces	1-3	1-2
Bologna / Sausage / Salami	Must be packed even if it has a membrane	1-2	Until it is well thawed
Chicken and turkey	Wrapped in foil	7-8	10-12
Goose / duck	Wrapped in foil	4-8	10
Venison, pork, rabbit	Portions of 2.5 kg and with no bones	9-12	10-12
Freshwater fish, trout, carp, catfish	It should be washed and dried after it is well cleaned inside and scaled, the tail and head parts should be cut off where necessary.	2	Until it is well thawed
Lean fish; sea bass, turbot, sole		4-8	Until it is well thawed
Fatty fish; bonito, mackerel, blue fish, anchovy		2-4	Until it is well thawed
Shellfish	Cleaned and put into bags	4-6	Until it is well thawed
Caviar	In its package, inside an aluminum or plastic cup	2-3	Until it is well thawed
Snail	In salt water, inside an aluminum or plastic cup	3	Until it is well thawed

Note: Frozen meat should be cooked as fresh meat after being thawed.

If the meat is not cooked after being thawed, it should never be frozen again.

FRUITS AND VEGETABLES	Preparation	Storage Duration (months)	Thawing period at room temperature (hours)
Cauliflower	Remove outer leaves and cut core in pieces. Then store in a container of water with a small amount of lemon juice.	10-12	Can be used without waiting to be thawed
Green beans, String beans	Wash them and cut into small pieces	10-13	Can be used without waiting to be thawed
Peas	Hull and wash them	12	Can be used without waiting to be thawed
Mushrooms and Asparagus	Wash them and cut into small pieces	6-9	Can be used without waiting to be thawed
Cabbage	In a cleaned fashion	6-8	2-In the room temperature
Eggplant	Cut it into pieces of 2 cm after washing it	10-12	Can be used without waiting to be thawed
Corn	Clean it and pack it with its cob or in kernels	12	Can be used without waiting to be thawed
Carrot	Clean them and cut into slices	12	Can be used without waiting to be thawed
Pepper	Remove the stem, cut in two, and remove the seeds/core	8-10	Can be used without waiting to be thawed
Spinach	Washed	6-9	2-In the room temperature
Apple and Pear	Peel and slice	8-10	5-In the refrigerator
Apricot, Peach	Divide it in half and remove the pit (stone)	4-6	4-In the refrigerator
Strawberry, Raspberry	Wash and clean them	8-12	2-In the room temperature
Cooked fruits	Inside a cup with addition of 10% of sugar	12	4-In the room temperature
Plums, Cherries, Sour Cherries	Wash them and remove the stems	8-12	5-7 - In the room temperature

Dairy Products and Pastries		Preparation	Storage Duration (months)	Storage Conditions
Milk			2-3	Only homogenized product
Cheese - other than white cheese		In the form of slices	6-8	They may be left in their original packages for short time storage. They should also be wrapped in plastic foil for long term storage.
Butter, margarine		In its own package	6	
Egg*	Egg white		10-12	In a closed container
	Egg mixture (white-yolk)	It is mixed very well, a pinch of salt or sugar is added to prevent it from getting too thick	10	In a closed container
	Egg yolk	It is mixed very well, a pinch of salt or sugar is added to prevent it from getting too thick	8-10	In a closed container

*Should never be frozen with its shell. Albumen and yolk should be frozen individually or completely mixed.

	Storage period (months)	Thawing period at room temperature (hours)	Thawing duration in the oven (minutes)
Bread	4-6	2-3	4-5 (220-225 °C)
Biscuits	3-6	1-1,5	5-8 (190-200 °C)
Pie	1-3	2-3	5-10 (200-225 °C)
Tart	1-1,5	3-4	5-8 (190-200 °C)
Phyllo dough	2-3	1-1,5	5-8 (190-200 °C)
Pizza	2-3	2-4	15-20 (200 °C)

Some spices in **cooked food** (aniseed, basil, dill, vinegar, spice mix, ginger, garlic, onion, mustard, thyme, marjoram, black pepper, bologna sausage etc.) may have a foul taste when stored for a long time. Therefore, frozen food should be spiced just a little or spice should be added after the food is thawed.

The storing time for the food depends on the oil used. Margarines, veal fat, olive oil and butter are suitable, peanut oil and lard are not suitable. Cooked food in liquid form should be frozen in plastic containers, other food should be frozen wrapped in plastic foil or in plastic bags.

CHAPTER 4. CLEANING AND MAINTENANCE

- ***Make sure to unplug the freezer before starting to clean it.***



- Do not wash your freezer by pouring water onto it.

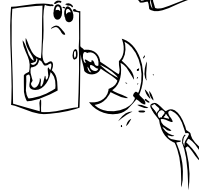

- You can wipe the inner and outer sides of your appliance with a soft cloth or a sponge using warm and soapy water.

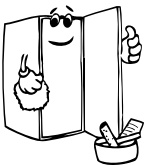

- Remove the parts individually and clean with soapy water. Do not wash in washing machine.



- Never use flammable, explosive or corrosive material like thinner, gas, acid for cleaning.

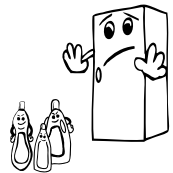

- The condenser (the back part with black wings) should be cleaned using a vacuum cleaner or a dry brush at least once a year. This will help your freezer to operate more efficiently and save energy.

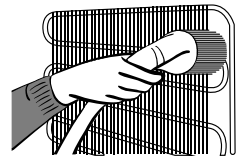

Make sure that your freezer is unplugged while cleaning.

Defrosting

- Your freezer defrosts automatically. Water produced by defrosting flows to evaporating container passing through water collecting groove, and vaporizes here by itself.

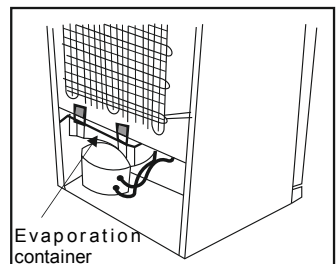

CHAPTER 5. SHIPMENT AND REPOSITIONING

- Original package and foam may be kept for re-transportation (optionally).
- You should fasten your freezer with thick package, bands or strong cords and follow the instructions for transportation on the package for re-transportation.
- Remove movable parts (shelves, accessories, vegetable bins etc.) or fix them into the freezer against shocks using bands during re-positioning and transportation.

Carry your freezer in the upright position.



Repositioning the door

- It is not possible to change the opening direction of your freezer door, if the door handle on your freezer is installed from the front surface of the door.
- It is possible to change the opening direction of the door on models without any handles.
- If the door opening direction of your freezer may be changed, you should contact the nearest Authorised Service to have the opening direction changed.

CHAPTER 6. BEFORE CALLING SERVICE

If your fridge is not operating ;

- Is there any electrical faults?
- Is the plug is placed properly in the receptacle?
- Is the fuse of the receptacle that the plug is plugged or the main fuse blown?
- Is there any fault in the socket? Examine this by plugging your fridge into a receptacle which you are sure that is working.

WARNING TYPE	MEANING	REASON	REMEDY
Sr	Failure warnings	Appears when one or more of the refrigerator parts fail or there is a problem in the cooling system.	Call service immediately.
LF	Freezer compartment is not cold enough	This warning appears if there has been a power failure for a long period and when the refrigerator is operated for the first time.	1-) If your frozen food is thawed, consume them as soon as possible and do not freeze them again since there is a risk of putrefaction.
			2-) Temporarily increase the freezer temperature setting to the desired level or switch the appliance to fast freezing mode.
LP	Low voltage	Refrigerator switches to the standby mode when the voltage supply falls below 170 Volts.	This feature prevents the compressor from getting damaged due to low voltage. Refrigerator will start operating automatically when the voltage restores to the required level.

Temperature Warning:

The temperature display flashes “LF” and an audible warning sounds, when the temperature in the freezer compartment is too warm.

A rise in the temperature may be caused by;

- Frequent door opening for long periods of time
- Loading with large quantities of warm foods
- High ambient temperature
- An error with the appliances.

Check Warnings;

Your freezer warns you if the temperatures for freezer departments are in improper levels or when a problem occurs in the appliance. Warning codes are displayed in the Freezer Department Indicators. Warning codes appear in the Freezer Compartment Setting Displays.

Also a warning sound are heard.

Showing code and buzzer will continue until you pushes SET or MODE button. When you push one of these buttons, buzzer will stop. “LF” warning will be disappear in 15 minutes. You don't have to call your service, this condition may appear due to reasons above. You can keep storing your foods in your freezer. If “LF” warning will not disappear in an hour after pressing the button, you can call your service and do not re-freeze your food. These foods must be eaten.

If your fridge is operating too loudly;

Normal Noises

Cracking (Ice cracking) Noise:

- During automatic defrosting.
- When the appliance is cooled or warmed (due to expansion of appliance material).

Short cracking

- Heard when the thermostat switches the compressor on/off.

Compressor noise

- Normal motor noise. This noise means that the compressor operates normally
Compressor may cause more noise for a short time when it is activated.

Bubbling noise and splash:

- This noise is caused by the flow of the refrigerant in the tubes of the system.

Water flow noise:

- Normal flow noise of water flowing to the evaporation container during defrosting.
This noise can be heard during defrosting.

Air Blow Noise:

- Normal fan noise. This noise can be heard in No-Frost fridge during normal operation of the system due to the circulation of air.

If the edges of freezer cabinet that the door joint contact are warm;

- Especially in summer (hot weather), the surfaces that the joint contact may get warmer during the operation of the compressor, this is normal.

If humidity builds up inside the freezer;

- Are all food packed properly? Are the containers dried before placing them in the freezer?
- Is the freezers door opened frequently? Humidity of the room gets in the freezer when the doors are opened. Humidity build up will be faster when you open the doors more frequently, especially if the humidity of the room is high.
- Building up of water drops on the rear wall after automatic defrosting is normal. (in Static Models)

If the door is not opened and closed properly;

- Do the food packages prevent closing of the door?
- Are the door compartments, shelves and drawers placed properly?
- Are door joints broken or torn?
- Is your freezer on a level surface?

If your freezer is not cooling enough;

Your freezer is designed to operate in the ambient temperature intervals stated in the standards, according to the climate class stated in the information label. We do not recommend operating your fridge out of stated temperatures value limits in terms of cooling effectiveness.

Climate Class	Ambient Temperature (°C)
T	Between 16 and 43 (°C)
ST	Between 16 and 38 (°C)
N	Between 16 and 32 (°C)
SN	Between 10 and 32 (°C)

IMPORTANT NOTES:

- Compressor protection function will be activated after sudden power breakdowns or after unplugging the appliance, because the gas in the cooling system is not stabilized yet. Your freezer will start after 5 minutes, there is nothing to worry about.
- If you will not use your freezer for a long time (e.g. in summer holidays) unplug it. Clean your freezer according to Chapter 4 and leave the door open to prevent humidity and smell.
- If the problem persists after you have followed all the instructions above, please consult to the nearest Authorized service.

Advice for Saving Energy

- Do not install the appliance close to heat producing appliances. Such as cooker, oven, dishwasher or radiator, and locate the appliance in the coolest part of the room.
- Locate the appliance in a cool well ventilated room and make sure that the air openings of the appliances are not obstructed.
- Always leave warm food to cool down to room temperature before placing in the freezer.
- Try to avoid keeping the door open for long periods or opening the door too frequently as warm air will enter the cabinet and cause the compressor to switch on unnecessarily often.
- Ensure there are no obstructions preventing the door from closing properly.
- Cover foods before placing them in the freezer. This cuts down on moisture build-up inside the unit.
- Refer to the “temperature settings” section for the suggested temperature control settings.
- Do not block cold air vents. Doing so causes the freezer to run longer and use more energy.
- Keep freezer full.
- Level the freezer so that the door closes tightly.
- Occasionally clean the rear of the appliance with a vacuum cleaner or paint brush to prevent an increased power consumption.
- Keep door gaskets clean and pliable. Replace gaskets if worn.

Conformity Information

- This equipment is designed for use at an ambient temperature within the 16°C - 43°C range.
- The appliance is designed in compliance with the EN62552, IEC60335-1 / IEC60335-2-24, 2004/108/EC standards.

CHAPTER 7.

THE PARTS OF THE APPLIANCE AND THE COMPARTMENTS

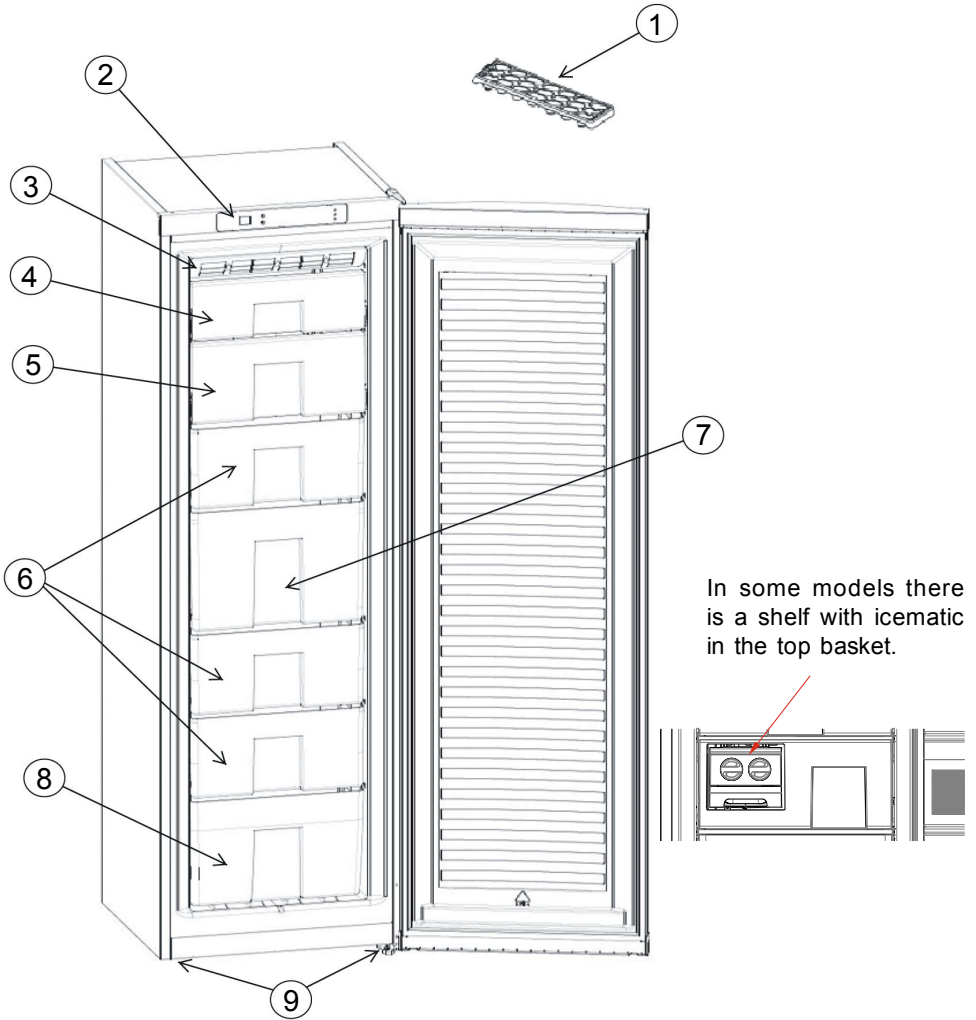

This presentation is only for information about the parts of the appliance.
Parts may vary according to the appliance model.

1. ICE TRAY

2. DISPLAY PANEL

3. NO FROST AIR CIRCULATION SYSTEM

4. SMALL FREEZER FLAP

5. BIG FREEZER FLAP

6. FREEZER DRAWERS

7. FREEZER BIG DRAWER

8. FREEZER BOTTOM DRAWER

9. LEVELLING FEET

a

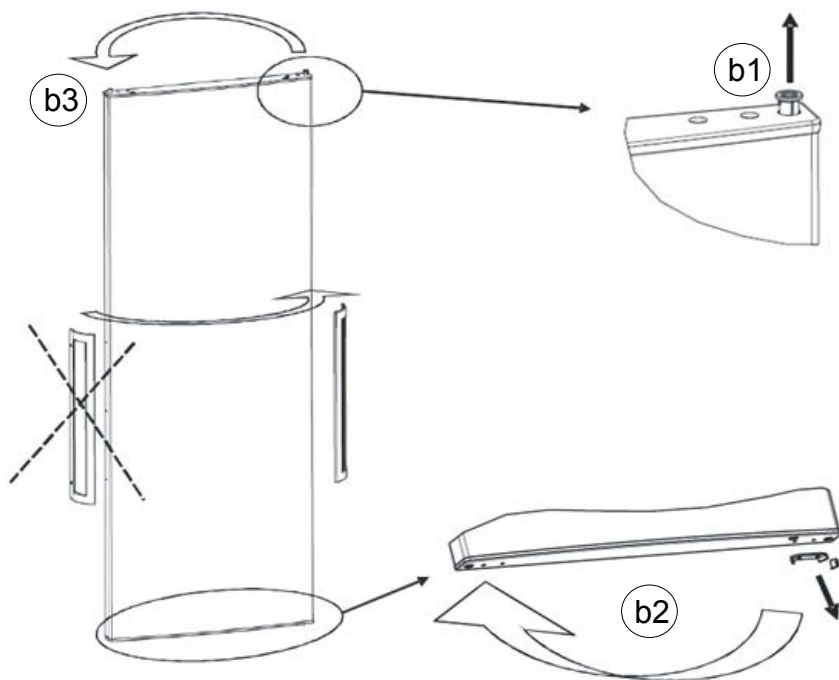
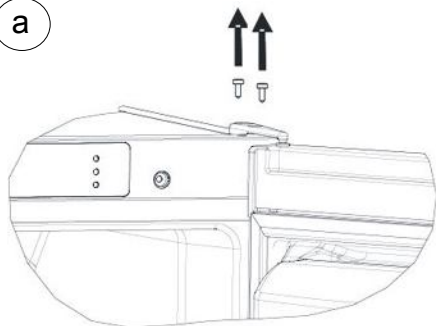

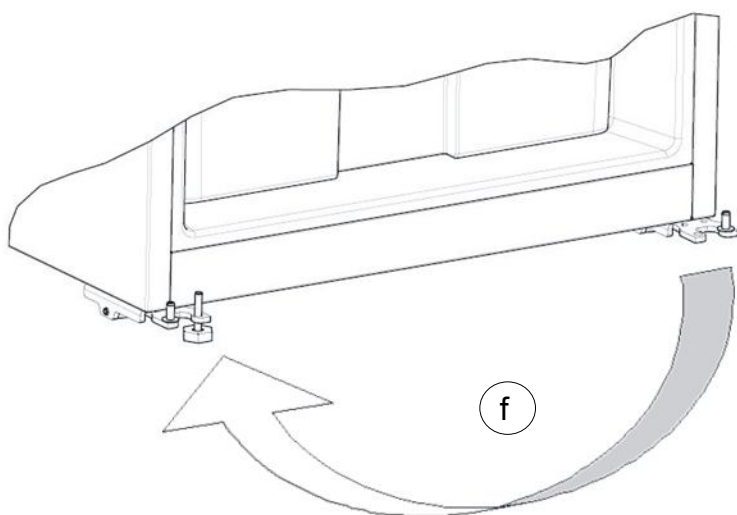
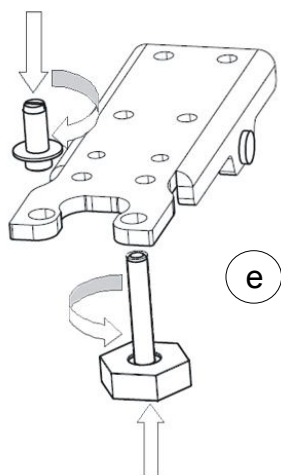
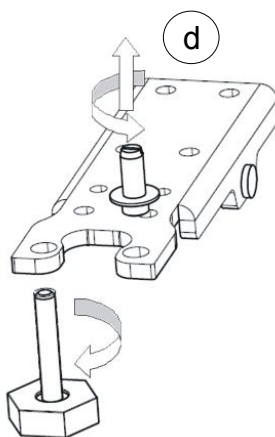



service

- Vi har service i hela landet
- Gå in på www.cylinda.se eller
- Ring 0771-25 25 00 (endast lokaltaxa)

uppgge

- Maskintyp
- Problembeskrivning
- Serienummer
- Namn och adress
- Inköpsdatum
- Ditt telefonnummer

Våra tekniker är specialutbildade på Cylindaprodukter och vi använder bara originalreservdelar.

Elektroskandia Sverige AB, Cylinda, 191 83 Sollentuna

Cylinda
år efter år
5218XXXX